

Instructor's Guide to Teaching SolidWorks Software Lesson 5

School's Name
Teacher's Name
Date



What is Toolbox?

- Ready-to-use standard parts such as bolts, screws, washers, lock washers, and so forth.
- Eliminates the need to model most fasteners and many other standard parts.
- Easy drag-and-drop placement.

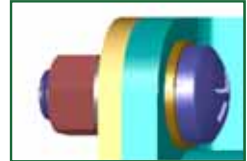

Toolbox Browser

- Browser containing libraries of ready-to-use components.
- Click to access Toolbox Browser.
- Contains libraries of ready-to-use parts.



Easy Drag-and-Drop Placement

- Drag from Toolbox Browser
- Snap to assembly



Mate Relationships Defined at Placement

- When the Toolbox part snaps to the assembly, the mate relationship between the Toolbox part and the other part is established.
- When using washers, place them first. Subsequent hardware — like screws and nuts — mate to the washers.

Standard Hardware Matches - Standard Holes

- Hardware placed on holes created using the Hole Wizard is appropriately sized.
- Standard sized parts help to keep your designs realistic.

Specifying Toolbox Part Properties

Change part properties to customize the hardware to your design.

- Specify the properties as you are placing the part.
- Ability to change the properties after the part is placed.



7



Thread Display

- Simplified — Represents the hardware with few details. Most common display.
- Cosmetic — Represents some details of the hardware.
- Schematic — Very detailed display which is used for unusual or custom designed hardware.

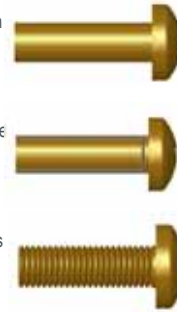

8



Supported Standards

Toolbox supports international standards

- ANSI
- BSI
- CISC
- DIN
- ISO
- JIS

© 2008 Autodesk, Inc. All rights reserved.



9



Libraries from Leading Manufacturers

Toolbox contains standard parts libraries from leading manufacturers such as:

- PEM®
- Torrington®
- Truarc®
- SKF®
- Unistrut®

© 2008 Autodesk, Inc. All rights reserved.



10

